

1. Preparation for wiring

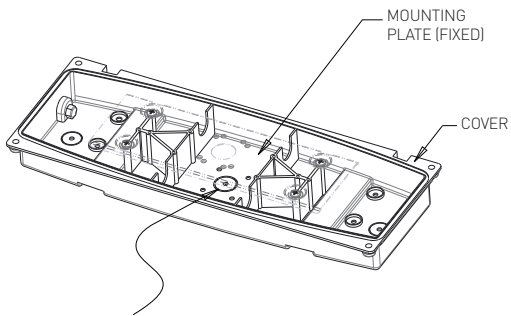

Drill cable entry hole on to cover depending on mounting position (mounting plate should not be removed from cover)

2. Preparation to mount bracket

Ensure mains wiring to terminal as per product instructions.

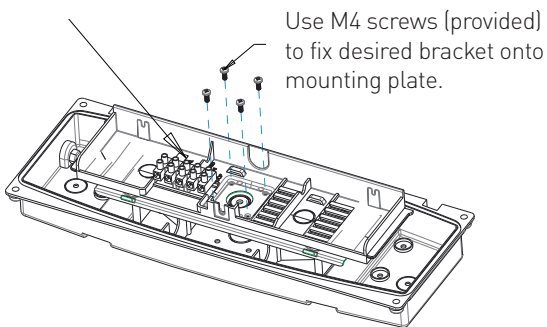

Note: Position of the bracket is to be determined by the EXIT direction at the stage.

3. Installation options

Wall mount

a) Install the wall mount bracket.

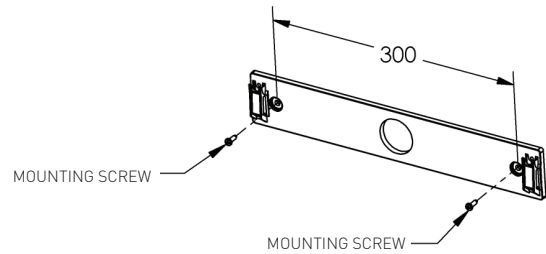

b) Slide the base over the wall bracket.

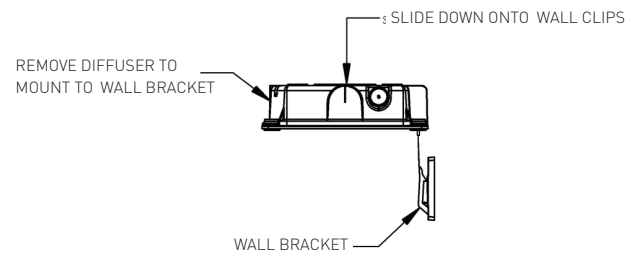

c) Secure the base to the wall bracket.

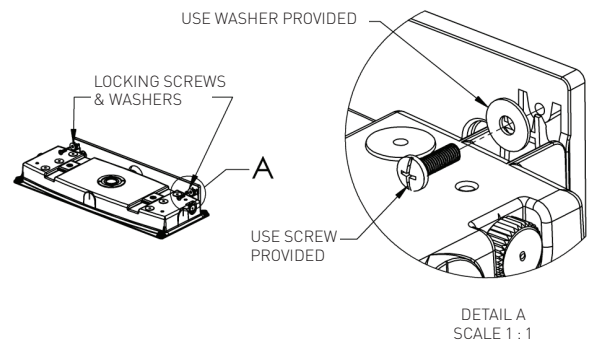

Ceiling mount

Secure the ceiling clips to the surface and clip onto the base.

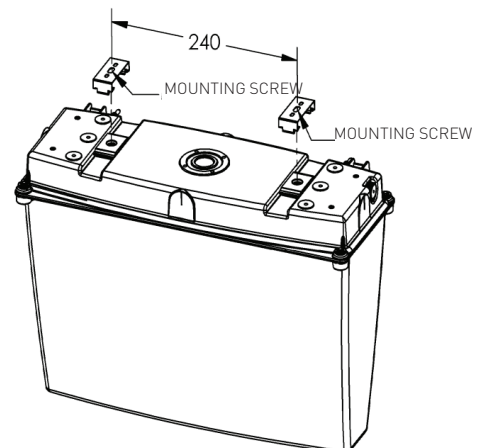

4. Mount the body to bracket

Install the exit sign onto the bracket.

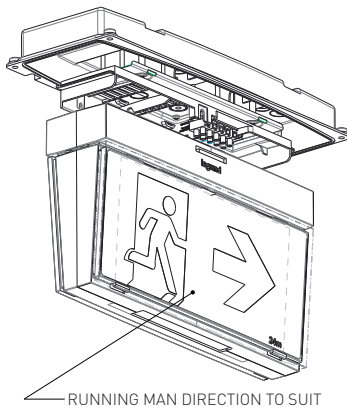

5. Close the enclosure

Fix the Hexagon nuts (x4) into pocket of the cover and then fix the clear housing onto cover with provided screws (x4).

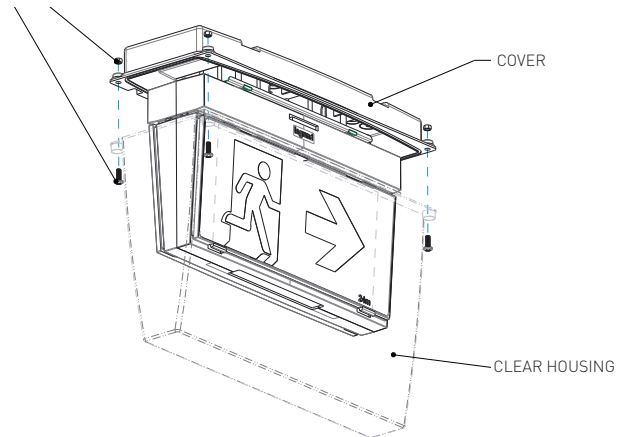

6. Close the gap between the housing

Ensure that the clear housing exactly lines up with the cover to ensure that the seal is watertight. Tighten the 4 screws so that the gap between the clear housing and the cover is less than 0.5 mm.

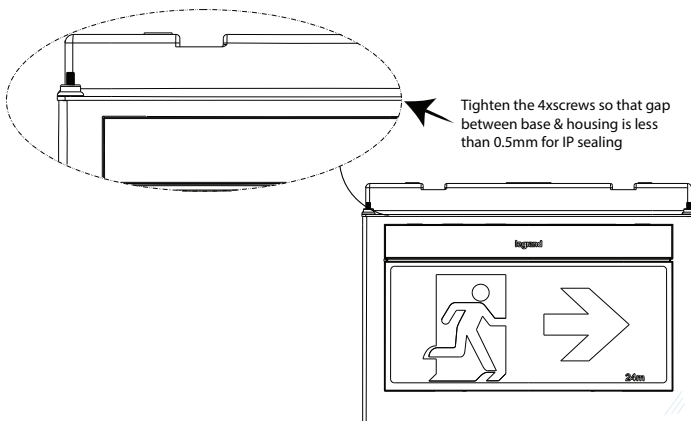

Disclaimer

Please review these instructions carefully before installing or maintaining this equipment. This information should be used as a guide only. Good electrical practice should be followed at all times when installing an electrical device within this enclosure. Please note that lamp wattages should not exceed 3 watts. Application of the IP65 weatherproof enclosure is designed to enclose an exit sign or emergency luminaire. The unit is supplied completed with a wall bracket and ceiling mount clips to enable quick installation without the need to perforate the housing. It is also fitted with an IP rated breather to equalise the internal temperature with the ambient to avoid the build-up of condensation inside. A gland is supplied to suit round flexible cable.

Warranty

Legrand Australia Pty Ltd guarantees this unit for a period of 12 months from the date of purchase. These goods come with guarantees that cannot be excluded under the Australian and New Zealand Consumer Laws. You are entitled to a replacement or a refund for a major failure and compensation for any other reasonably foreseeable loss or damage. You are also entitled to have the goods repaired or replaced if the goods fail to be of acceptable quality and the failure does not amount to a major failure.

See the Warranty card enclosed with this product for further details.

Customer Service

For all Customer Service and Technical Support enquires please call Monday to Friday during business hours.

Legrand Australia
1300 369 777
www.legrand.com.au

Legrand New Zealand
0800 476 009
www.legrand.co.nz

ABN: 31 000 102 661

